

# Drawer and Cabinet Specifications

## Drawer box specification

Front view

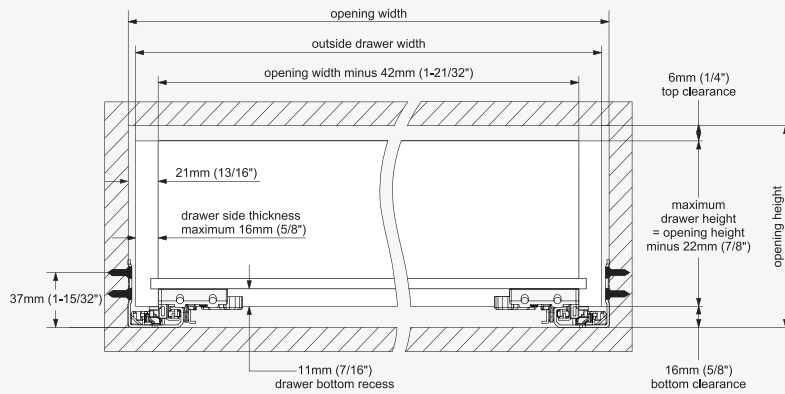

**Note:** The inside drawer width must equal Cabinet opening width minus 42mm (1-21/32") to align and function optimally

### Calculating outside drawer width

For drawer side panel thickness	16mm (5/8")	15mm (19/32")	14mm (9/16")	13mm (1/2")	12mm (15/32")
Deduct from inside cabinet width	10mm (3/8")	12mm (15/32")	14mm (9/16")	16mm (5/8")	18mm (23/32")

**Example:** For 508mm (20") inside cabinet width and a 16mm (5/8") thick drawer panel, 508mm (20") minus 10mm (3/8") = 498mm (19 5/8") drawer width.

## Drawer back preparation

Rear view

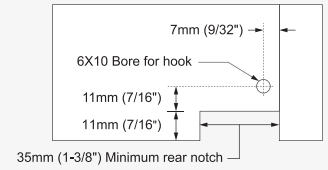

### TCH- 23000 R.P.01 Rear mounting

Front view

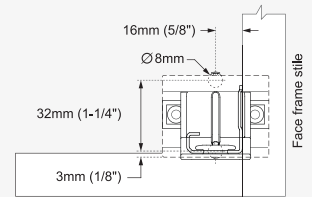

### TCH- 23000 R.S.01 Rear mounting

Front view

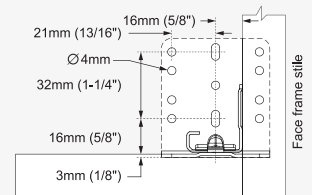

## Runner mounting specifications

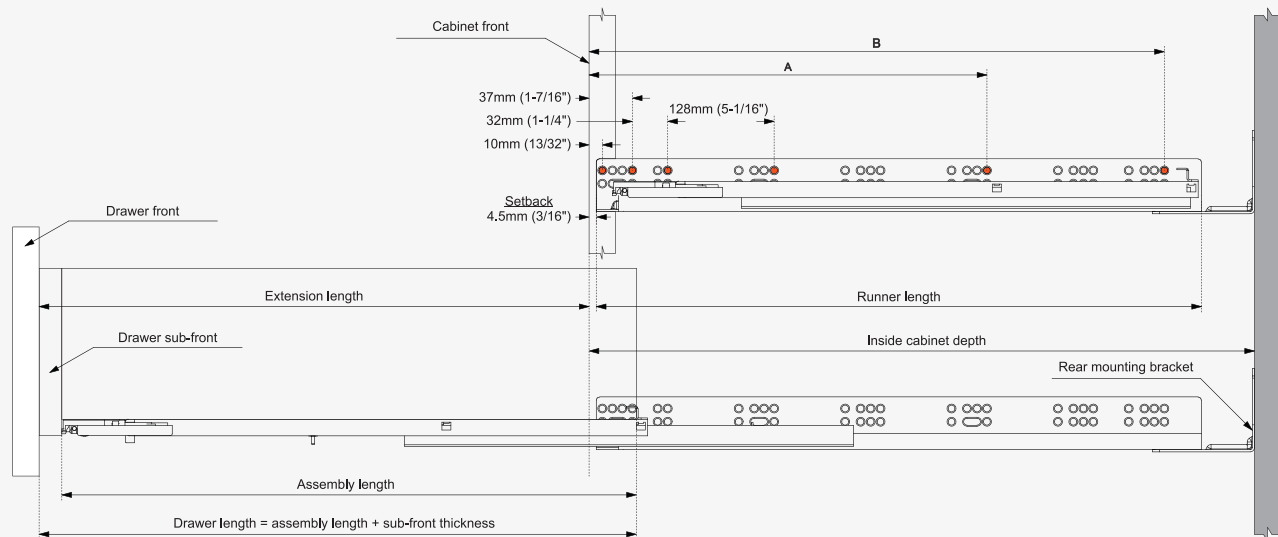

Runner SKU number	Nominal length	Runner length	Assembly length	Extension length	Screw locations for frameless cabinet		Inside cabinet depth with rear attachment	
					A	B	Minimum	Maximum
TCH-23102 16.305.3D	305mm (12")	318mm (12-1/2")	289mm (11-3/8")	249mm (9-13/16")	-	261mm (10-9/32")	343mm (13 1/2")	368mm (14 1/2")
TCH-23102 16.381.3D	381mm (15")	394mm (15-1/2")	365mm (14-3/8")	337mm (13-9/32")	261mm (10-9/32")	357mm (14-1/16")	419mm (16 1/2")	445mm (17 1/2")
TCH-23102 16.457.3D	457mm (18")	470mm (18-1/2")	441mm (17-3/8")	403mm (15-7/8")	357mm (14-1/16")	453mm (17-27/32")	495mm (19 1/2")	521mm (20 1/2")
TCH-23102 16.533.3D	533mm (21")	546mm (21-1/2")	517mm (20-3/8")	489mm (19-1/4")	357mm (14-1/16")	517mm (20-11/32")	572mm (22 1/2")	597mm (23 1/2")